

AC Solid State Relay

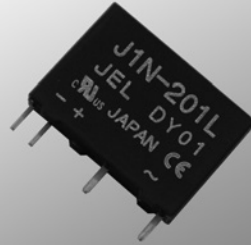

J1

SERIES



Solid State Relay

J1 series

Features

- Miniature size, Slim appearance
- Max. load current at 1.5A
- Available for PCB high-density packaging
- Dielectric strength between input and output at 3,000V/1 min.
- UL/C-UL standard approved

Type Information

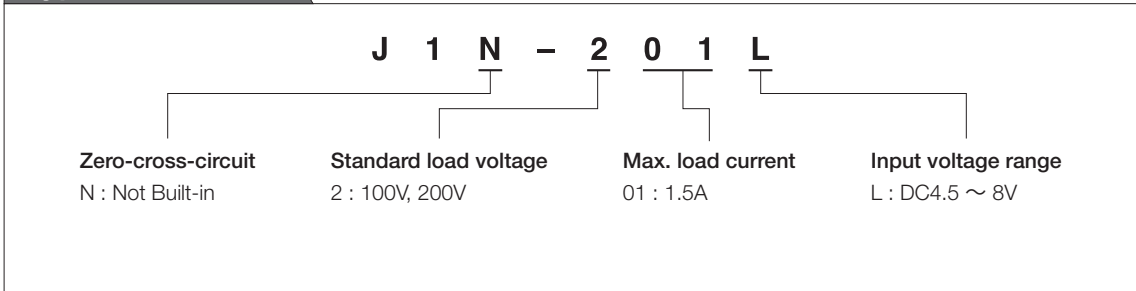

Characteristics

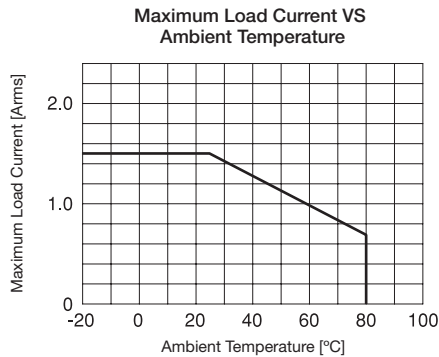

※ Description in the catalogue is subject to change without notice. Please read the specifications thoroughly before using.
 ※ Please contact JEL SYSTEM for further information.

Dimensions (mm)

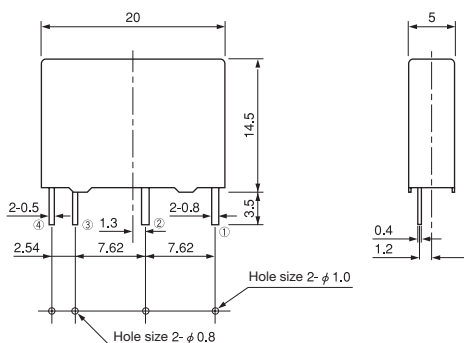

Dimensions For PCB Design

Equivalent Circuit

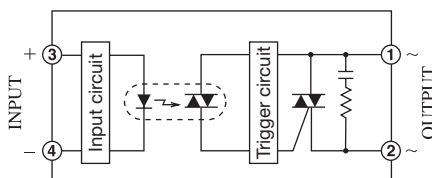

※ Description in the catalogue is subject to change without notice. Please read the specifications thoroughly before using.
 ※ Please contact JEL SYSTEM for further information.

(Ta = 25 °C)

■ Ratings

	Item	Symbols	J1N-201L	Units
Output	Rated Load Voltage	—	120、240	V _{ACrms}
	Maximum Load Current	I _{OMAX}	1.5	A _{ACrms}
	Maximum Load Voltage	V _{OMAX}	264	V _{ACrms}
	Peak Repetitive Off State Voltage	V _{DRM}	600	V
	Peak 1 Cycle Surge Current	I _{SURGE}	50 (60Hz)	A
	Frequency	f	50、60	Hz
Input	Maximum Input Voltage	V _{IMAX}	8	V _{DC}
	Input Impedance	R _{IN}	390 ± 20%	Ω
General	Dielectric Strength	V _{ISO}	3,000/1 min.(Between input and output)	V _{ACrms}
	Isolation Resistance	R _{ISO}	10 ⁹ and above DC500V(Between input and output)	Ω
	Operating Temperature Range	T _{OPR}	- 20 ~ + 80	°C
	Storage Temperature Range	T _{STG}	- 30 ~ + 100	°C

■ Electrical Characteristics

	Item	Symbols	J1N-201L	Units
Output	Load Voltage Range	V _O	50 ~ 264	V _{ACrms}
	Off State Leakage Current	I _{LEK}	1.0 and below (V _O = 200V)	mA _{ACrms}
	On State Voltage Drop	V _{SAT}	1.5 and below	V _{ACrms}
	Minimum Load Current	I _{OMIN}	10	mA
Input	Input Voltage Range	V _I	4.5 ~ 8	V _{DC}
	Operate Voltage	V _P	4.5 and below	V _{DC}
	Release Voltage	V _D	1 and above	V _{DC}
General	Operate Time	T _{ON}	1ms and below	/
	Release Time	T _{OFF}	1/2 Cycle + 1ms and below	/
	Capacitance	C _{IO}	15 and below	PF
	Zero Cross Turn On		Not Built In	/
	Approved Standards		UL、C-UL	/

※ Description in the catalogue is subject to change without notice. Please read the specifications thoroughly before using.
 ※ Please contact JEL SYSTEM for further information.

Peak Surge Current VS Duration

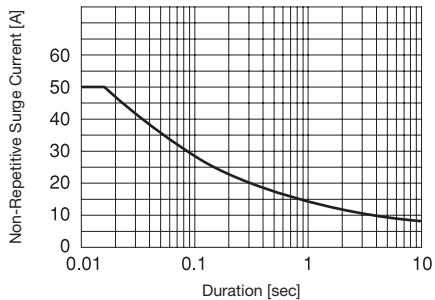

Input Current VS Input Voltage (Typical value)

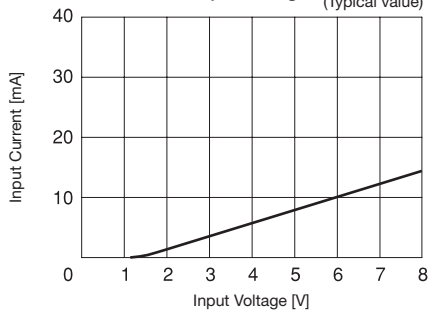

Input Characteristics VS Ambient Temperature (Typical value)

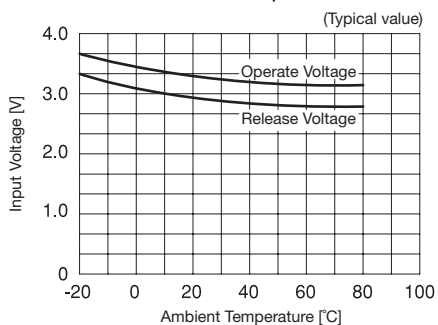

※ Description in the catalogue is subject to change without notice. Please read the specifications thoroughly before using.
 ※ Please contact JEL SYSTEM for further information.